

quality . service
innovation . integrity

Model 222



"The color green
is a registered
trademark of
Zoeller Pump Co."

Features

This series of submersible pumps is designed for use in residential or light commercial dewatering and wastewater applications, and can be used to transfer groundwater and effluent or unscreened raw sewage. The innovative vortex impeller design reduces the risk of clogging and allows each pump to pass a 50 mm (2") spherical solid. The durable cast iron components include a rust-resistant, baked-on enamel finish, and are designed to provide great heat dissipation from the motor, ensuring a long service life. As with every Zoeller pump, each one is 100% pressure-tested, submerged and run to ensure quality and reliability for years of trouble-free performance! This attention to detail is an inherent feature of every pump in this series, making it one of the most reliable in the industry.

- Automatic units include a float-operated, NEMA 6, 2-pole mechanical switch, an engineered plastic float guard and switch arm, and a vertical float switch.
- For nonautomatic pumps, variable level control systems and containers of various sizes are available for longer cycles.
- Includes an engineered plastic carrying handle for easy transport.
- All models are hermetically sealed to be watertight, dust-tight, and completely submersible.

Specifications

Motor Characteristics

Motor	1.03 kW
Voltage	220 V
Phase	1 Ph
Hertz	50 Hz
RPM	2800 RPM
Type	Permanent split capacitor
Insulation	Class B
Amps	5.2 A

Pump Characteristics

Operation	Automatic or nonautomatic
Auto On/ Off Points	24 cm / 14 cm (9-7/16" / 5-1/2") standard
Discharge Size	2" NPT (CE models BSPT)
Solids Handling	50 mm (2") spherical solids
Cord Length	4.5 m (15') standard
Cord Type	H07RN-F
Max Head	8.2 m (27')
Max Flow Rate	400 LPM (106 GPM)
Max Operating Temp	40 °C (104 °F)
Cooling	Oil filled
Motor Protection	Auto reset thermal overload

Materials Characteristics

Cap	Engineered plastic
Motor Housing	Cast iron
Pump Housing	Engineered plastic
Base	Engineered plastic
Upper Bearing	Ball bearing
Lower Bearing	Ball bearing
Mechanical Seals	Carbon and ceramic
Impeller Type	Non-clogging vortex
Impeller	Engineered plastic
Hardware	Stainless steel
Motor Shaft	Carbon steel
Gasket	NBR



PUMP COMPANY

Zoeller Family of Water Solutions™

FM2717_Eb
Section W2.30.010
Updated 0816
Supersedes 0216

Model 222

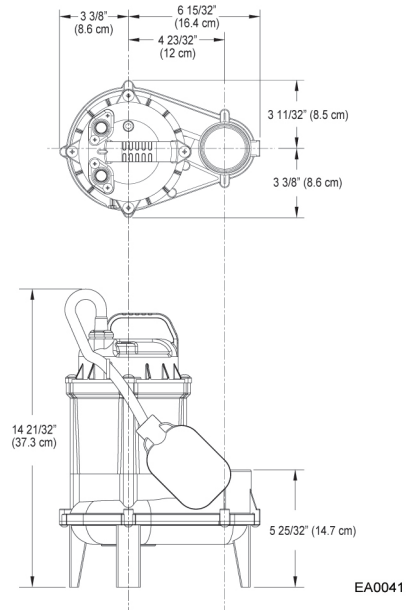
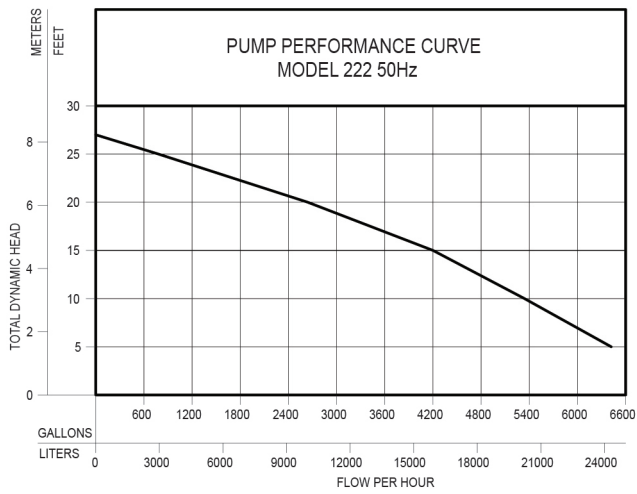

Model

Model Number	Mode	Volts	Phase	Amps	HP	KW (p1)	Hz	Kg	Lbs
V222	Non	220	1	5.2	3/4	1.03	50	8.8	19.4
U222	Auto	220	1	5.2	3/4	1.03	50	9.0	19.8
WU222	Auto	220	1	5.2	3/4	1.03	50	9.1	20.1

Your Peace of Mind is Our Top Priority®
 3649 Cane Run Rd | Louisville, KY 40211 USA
 +1 502-778-2731 | 1-800-928-7867 | Fax: +1 502-774-3624
www.zoeller.com